



PSX preparation guide

Five points for using PSX for a long time

Preparing for this unit can be easily done by anyone who has experience connecting a VCR to come.

However, unlike conventional VCRs, this unit does not support precision devices such as hard disks.

Because it is equipped with a machine,

If you do the preparation work without knowing some precautions, you may damage the machine or make it work incorrectly. recording may not be possible.

In order to ensure that you will be able to use this unit satisfactorily after preparations have been made, be sure to observe the following five points. be prepared.

**Point 1** Precautions when connecting

If you connect this unit incorrectly, the hard disk of this unit may be damaged or the antenna may be damaged. You may. Be sure to observe the following cautions.

When connecting, connect with the top side of the unit facing down.

1 Push the once, then 2 Pull it forward.

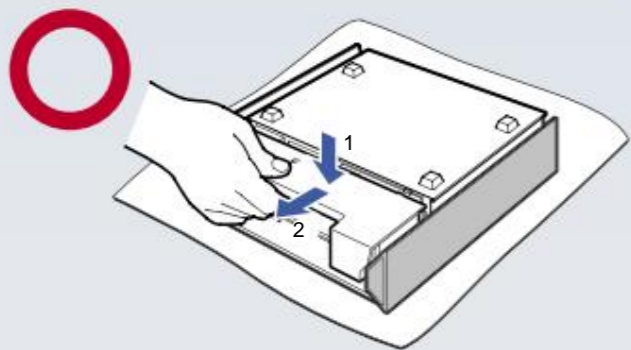

If you use the included distributor, you can also connect the antenna to the TV.

This unit does not have an antenna output terminal.

Must use. This unit comes with two distributors. Please connect na.

Connect the supplied cable to the BS IF input terminal.

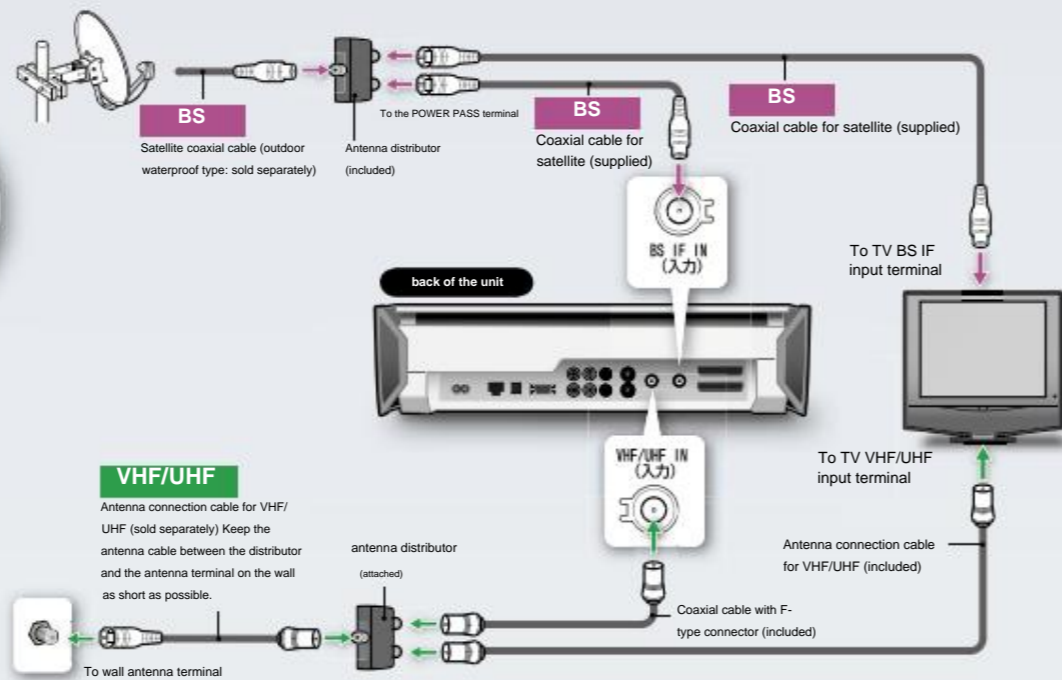

When supplying power from this unit to the BS antenna, connect the terminal labeled POWER PASS on the distributor to the BS IF input terminal of this unit.

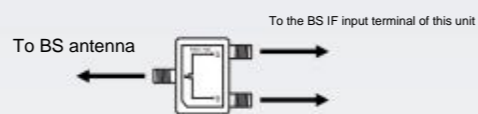

When supplying power to the BS antenna on the TV side, connect the terminal labeled POWER PASS on the distributor to the BS IF input terminal on the TV.



See page 16 of the Owner's Manual for connection to the TV using the AV cord.

When this unit and TV are connected with a video cord or S-video cord, set the progressive output setting of this unit to "Off".

Select "On" in "Set progressive output" (page 101) in "DVD settings" of this unit. No image is displayed even if output is output. In such cases, leave the setting as "Off". If DVD images are not displayed, please check the progressive output setting.

**Point 2** Installation point

This unit can be placed horizontally or vertically, but discs such as CDs and DVDs will not work properly if placed in any other way than specified.

Be sure to install the unit according to the correct installation method.

Correct installation

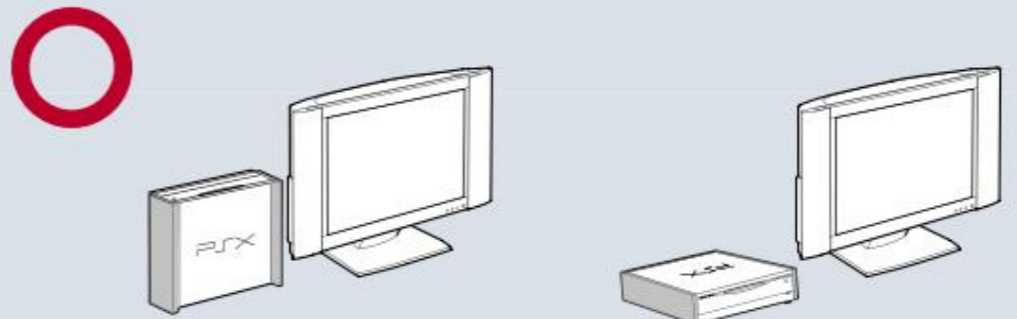

bad installation

The machine will not work properly with this setup.

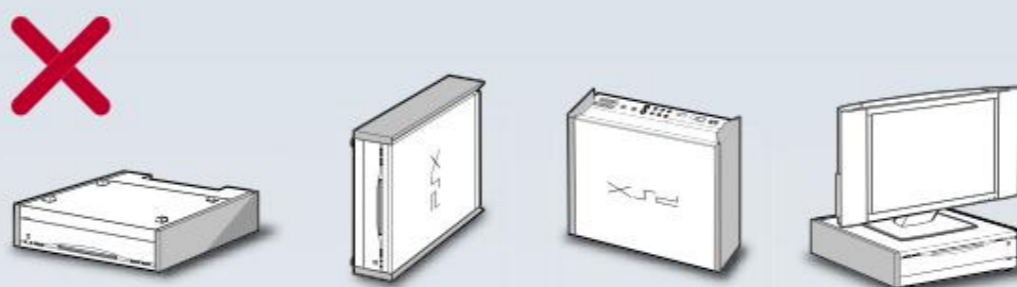

**Point 3** Precautions for "Easy Setup"

When the connection and installation are completed and the power of this unit is turned on for the first time, the simple setting screen is displayed. You can set it simply by following the instructions displayed on the screen, but if you make a mistake in the setting, you will not be able to use the program guide correctly. increase. Be sure to observe the following cautions.

Please set the time correctly

If the time is not set correctly, you may not be able to receive the program guide data or the scheduled recording may not work on time. The unit is shipped from the factory with the time set in advance, but just in case, check that the current time matches the unit's time. For details, see page 20 of the Owner's Manual.

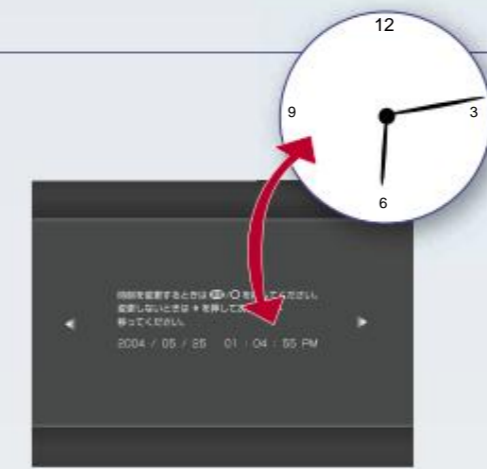

Please also check the channel settings automatically set in the area code setting just in case.

If you do not select the correct area code for your area in the default area code setting, the program guide will not be displayed correctly. It may not be set and you may not be able to schedule recording.

Also, in the following cases, manual channel setting is required to obtain the program guide data. Please note that it may become

- The displayed channel in the guide channel list (page 136 of the instruction manual) is different from the TV channel
- If you are using cable TV or an apartment community reception system, etc., the guide channel list display channel is different

**Point 4** Point of reception of program guide

Data such as program names to be displayed in the program guide is sent several times a day from a specific TV station through the TV antenna. provided periodically. This unit stores program guide data when it is turned off or when you are playing a game on this unit.

The program guide cannot be used at the time of purchase.

At the time of purchase, program guide data is not stored in this unit, so the program guide cannot be used until the power is turned off and the program guide data is received. If you change the area code, get the program information of the program guide. The time to start is also set automatically. Please turn off the power during the time period to be acquired.

For the acquisition time, see Settings: TV settings (page 96). change the set time please don't



Precautions regarding acquisition of program guide data

•Program guide data can only be obtained when this unit is turned off or when a game is being used on this unit. Only when Otherwise, the program guide cannot be obtained.

•When you use this unit for the first time after purchase, the program guide data will not be displayed until the program guide is downloaded. The time it takes to send program guide data is determined by the broadcasting station (host station) that sends the program guide data. It may take several days.

You can enjoy the functions of this unit other than the program guide even when the data of the program guide is not obtained.

•Depending on the radio wave conditions and the occurrence of ghosts, it may not be possible to acquire the program guide data.

**Point 5** Points for handling this machine

For basic preparation of this unit, refer to "Preparation 1 Checking the Accessories" to "Preparation 7 Easy Setup" in the Operating Instructions. If you have completed the above, you are finished, but if you do not observe the following precautions while using the unit, it may lead to a malfunction of the unit.

Do not pull out the power cord or move the main unit when the power is on.

Hard disks have built-in safety mechanisms to protect data from vibrations, shocks, and dust, but improper use can result in loss of recorded data or damage. In particular, be sure to observe the following precautions. - Do not move the unit or change its orientation while the power cord is plugged in. - When you plug or unplug the power cord or turn the power on and off, immediately move or move the do not Wait about 20 seconds after turning off the power.

Make sure that there is no disc in this unit before inserting the disc.

If you try to insert a disc while it is inside the unit, the disc may be damaged. I will.

Check basic operations

How to operate the remote control

This unit can be operated using only the following remote control buttons.

**△ button**

- Display optional functions
- Press when you want.
- The operation panel was displayed.
- Press when

**home button**

- displayed the home menu
- Press when you want to exit/return

At the time of purchase, the remote control mode of this unit is set to "1". Since it is set

Also set to "1" on the remote control side please.

For descriptions of other buttons on the remote control, see "Part names" (page 140).



It is a key that can be used on the TV.

- /Enter button**•When playing back content press it.
- Press to confirm the item selected on the menu.

**the cross key**

- If you move the cursor displayed on the menu, I use it when
- Turn off the wizard screen
- Used when replacing.

**X button**

- Stop playback and
- Used to return to the menu increase.
- Press to return to the previous menu.

Home menu introduction

電源を入れ、本機が起動するとホームメニューが表示されま

Select a category such as TV, Video, Music, Photo, PSBB, etc. from the home menu to use the contents and functions of each category.

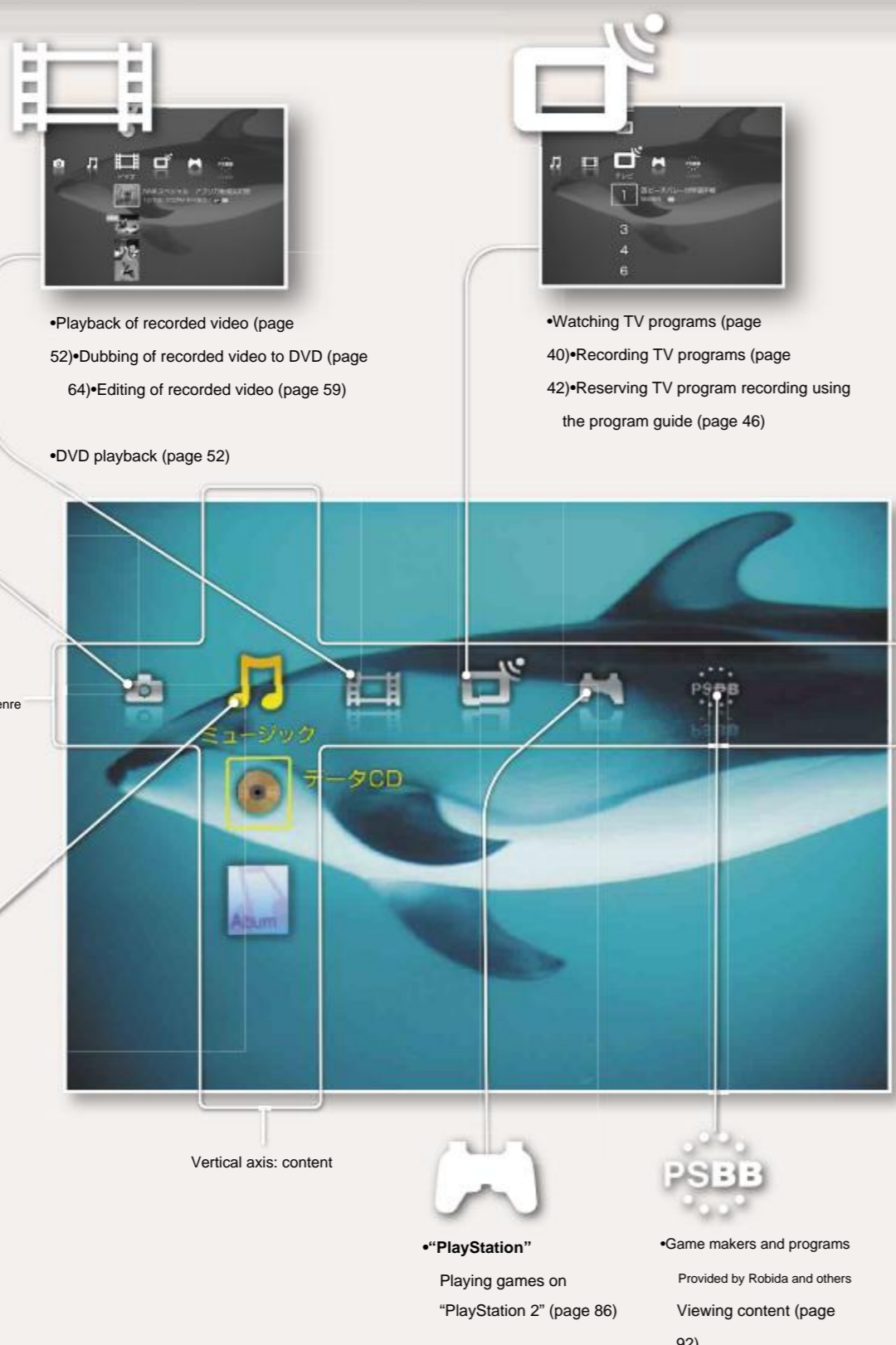

- Playback of recorded video (page 52)
- Dubbing of recorded video to DVD (page 64)
- Editing of recorded video (page 59)

- DVD playback (page 52)

- Watching TV programs (page 40)
- Recording TV programs (page 42)
- Reserving TV program recording using the program guide (page 46)

Horizontal axis: genre

Vertical axis: content

- "Memory Stick" and digital cards
- Camera, photos and videos saved on CD-R playback (page 80)

- "Memory Stick" or digital camera
- a hard copy of photos and videos saved on a CD-R.
- Save to Hard Disk (page 84)

- Playback of songs recorded on a CD or CD-R
- Raw (72 pages)
- Saving songs recorded on a CD or CD-R to the hard disk (page 75)

- "PlayStation"
- Playing games on "PlayStation 2" (page 86)

- Game makers and programs
- Provided by Robida and others
- Viewing content (page 92)

List of discs that can be played/dubbed on this unit

You can use various types of discs with this unit. The discs that can be used differ depending on the functions of this unit.

Discs that can be played with video

of the disc type	Disc name	DVD-ROM	DVD-R	DVD-RW	DVD+RW
logo					
mode			Video mode VR mode	Video mode + VR mode	
	Display on this unit	DVD-Video	DVD-Video DVD-VR	DVD-Video	DVD+VR

Discs that can be dubbed with video

of the disc type	Disc name	DVD-R	DVD-RW	DVD+RW
logo				
mode		Video mode	VR mode	Video mode + VR mode
	Display on this unit	DVD-Video	DVD-VR	DVD-Video
Maximum recording time		about 6 hours		
Compatibility with other devices				
	DVD player playable in	DVD player	VR mode compatible	DVD player
			Playable only on device and playable	+RW compatible device
Number of times that can be dubbed		Only once	Any number of times possible by initializing	Possible any number of times by initializing
Notes after dubbing				
Create DVD menu				
Create playlist				
Dubbing of				
main audio only		*2	*2	*2
bilingual broadcasting				
secondary audio only		*2	*2	*2
Main audio + secondary audio				
		*1	*3	*1

\*1 Recorded with the audio selected in the "DVD dual language recording audio" setting. \*2 Only the audio of the HDD bilingual recording audio set at the time of recording is dubbed. \*3 Both main and sub-audio are dubbed, and can be switched between main and sub-audio during playback.

Discs that can be played with Music (play music)

Only music CDs and CD-Rs can be played on this unit. CD-RW is not supported. For information on how to create a CD-R on a computer so that it can be played on this unit, see "Notes on playing MP3 files saved on a CD-R on this unit" (page 77).

Disc type	Disc name	CD	CD-R
logo			
operation		Commercially available software CD recorders or CDs created with a computer that record music and voice.	Music formats and MP3 files only playable

Discs that can be played with Photo

CD-R is the only disc that can be played back with Photo on this unit. For information on how to create a CD-R on a computer so that it can be played on this unit, see "How to save files to a CD-R" (page 123).

game disk

Disc type	"PlayStation 2" Specifications	"PlayStation 2" Logotype	"PlayStation" Logotype
Mark (logo) on the disc			
disc color	Silver/Gold	green	black
what is recorded	audio + video		
disk size	12cm		

Discs not compatible with this unit

- This unit does not support the following discs
- DVD-RAM
  - DVD-Audio
  - DVDs with area codes (region codes) that cannot be played on this unit video
  - CD-RW
  - Video CD
  - Super VCD
  - HD (High Density) layer of Super Audio CD
  - Discs compatible with color TV systems other than NTSC (PAL, SECAM) (because this unit is compatible with NTSC color TV systems)